

SYMPHONY SURFACE

DUET

310.8312.xxx

+ 310.8613/23/35/47.02.xxx

FEATURES

- The Symphony Surface Mount is installed directly to your desktop to create an integral component of your work area.
- The Symphony Duet is the recommended model for most surface mount installations.
- By adding any of the Symphony multi-purpose hooks and storage accessories, you can create perfect organizational functionality in your home office, craft room or vanity area.

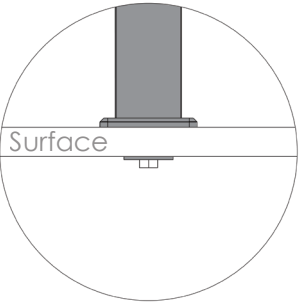
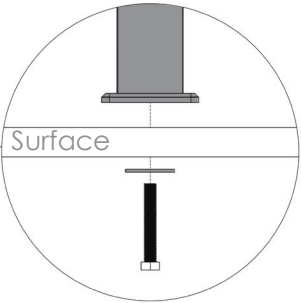
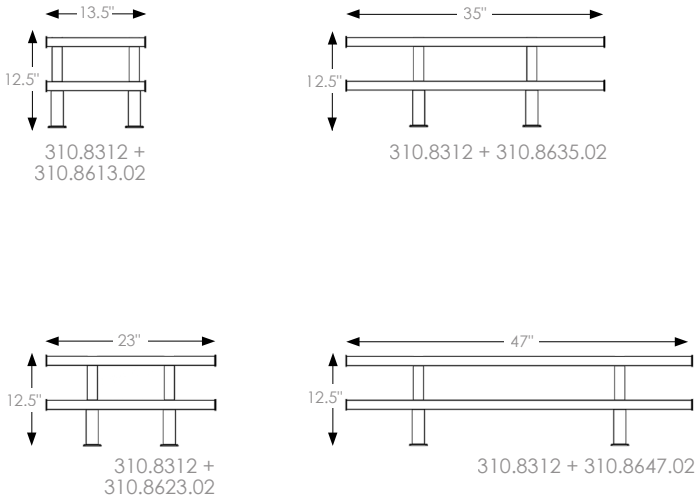

DIMENSIONS

SPECS

VERTICAL MOUNTS (2)

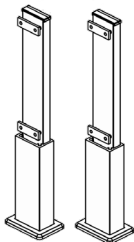

310.8312.xxx

IMITATION LEATHER BARS (2)

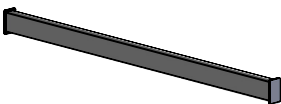

310.8613.02.xxx

310.8623.02.xxx

310.8635.02.xxx

310.8647.02.xxx

LOAD CAPACITY

The max. load capacity of a Single Horizontal bar is 50lbs, if the load is evenly spread along the bar.

The max. load capacity of a Full System is 200lbs, if the load is evenly spread along the system. (same limitation for all the sizes)

These tests have been performed on a ½ inch drywall, using 3-16 heavy duty toggle bolts and 10-24 steel machine screws.



310.8312.SG

+ 310.8647.02.PWT

FINISHED PRODUCT

OPTIONS

FINISH:

MAL

MNL

SG

MG

BLK

MATTE ALUMINUM

MATTE NICKEL

SLATE

MATTE GOLD

BLACK

IMITATION LEATHER:

WIN

OYS

PWT

WINTER

OYSTER

PEWTER

WIDTH:

13.5"

23"

35"

47"

HEIGHT:

12.5"